



Before you start to work on the car please disconnect the battery (check to see if you have the radio code written down!)

Remove the OEM sill plates from the vehicle by pulling them upwards from the door sill (short pull).

On the rear side of the sill plates you just removed, bend the tabs from the metal insert (10 tabs per Sill) facing upwards. (pic 2)
Now remove the metal insert and also remove any adhesive residue on the front of the sill plate. (pic 1)



pic 1

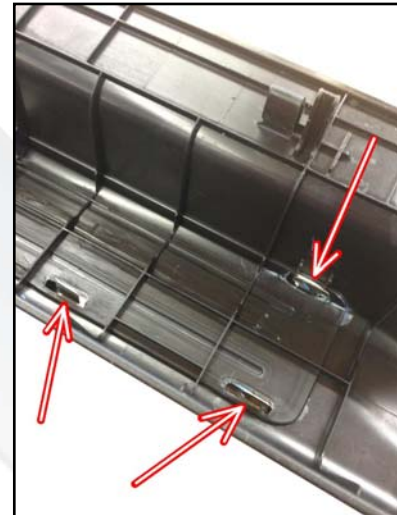

pic 2

To install the new illuminated metal inserts, you will need to modify the plastic sill by making a cutout in the sill.

Please use the two part template supplied in this manual to highlight the cutout on the sill. (template 1)
Position the template on the sills as shown in pic 3 and pic 4.



pic 3



pic 4

When you made the cutouts on the sills you can install the illuminated plates with the supplied double sided adhesive tape and bend the tabs of the insert plates sideways to fixate the plates on the OEM sills. (pic 5)



pic 5



Connect the cable from the insert plates with the supplied extensions cables, (driver side 1m and passenger side 2m) and install the door sills on the car. Move the extension wires behind the panels / carpet towards the steering wheel. (pic 6)



pic 6

Connect the inverter (pic 8) as shown below to the vehicle. Remove the panel below the steering wheel by giving a short pull on points 1 & 2 . (pic 9)

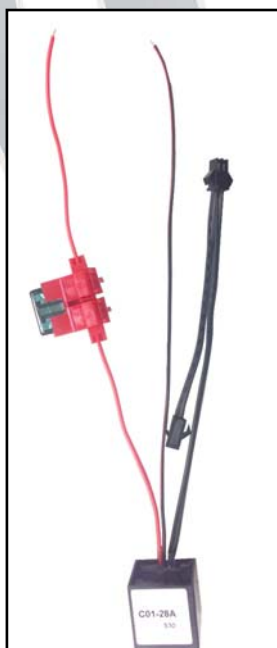

pic 8



pic 9



Now you can connect the inverter to the wiring loom of the vehicle.

The black cable is connected to connector C11 with the black/blue wire.(pic 10)

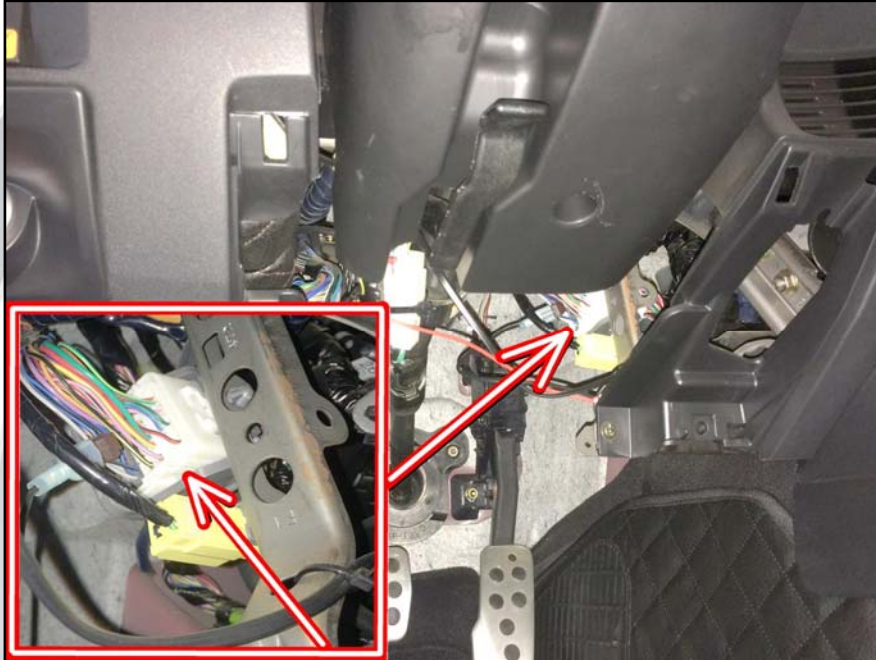

pic 10

the red cable with the fuse is connected to connector C04 on the blue/red cable.(pic 11)

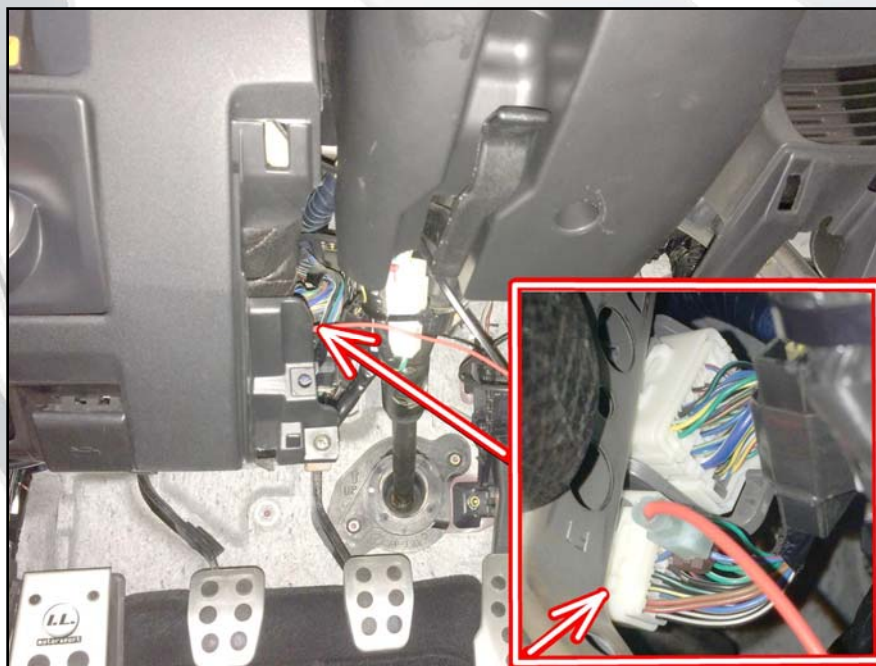

pic 11

You can now connect the inverter wiring with the extension cable you earlier placed under the steering wheel. The roadster sill plates will now illuminate when the doors are opened.



Template 1

Cut out template 1 and 2 using the marked lines.

Stick template 1 on the hatched surface area of template 2.
The arrows should be facing each other on opposite sides.

When you have glued the templates together, you will have to cut out the grey area of the template.
Now you can use the template on the OEM door sill to highlight the cut out area.

